



Single Family

Plan 1565

Mustang Meadows 40's

Plan 1565 is a thoughtfully designed single-story home that maximizes livability without wasted space. The open family room flows seamlessly into the dining area and kitchen, creating a comfortable everyday gathering space. The primary suite is privately positioned at the rear of the home and includes a walk-in closet and en-suite bath for added privacy. Two secondary bedrooms are located toward the front of the home with a shared full bath, making this plan ideal for first-time buyers, downsizers, or small families. Located just minutes from schools, shopping, and dining, Mustang Meadows is the perfect place to make lasting memories. For more details or to express interest, contact us today!

Priced From
\$294,900

2 Elevations Available

-  **3** Bedrooms
-  **2** Bathrooms
-  **1,565+** Sq. Ft.
-  **2** Car Garage



All square footage is approximate. Renderings are artist's conceptions and may vary slightly from the actual home. Homes may be built in reverse of plans shown, depending on site conditions. Minor architectural changes may be made occasionally at the option of the builder. Please contact your Sales Consultant for details.

Elevation 1565 A

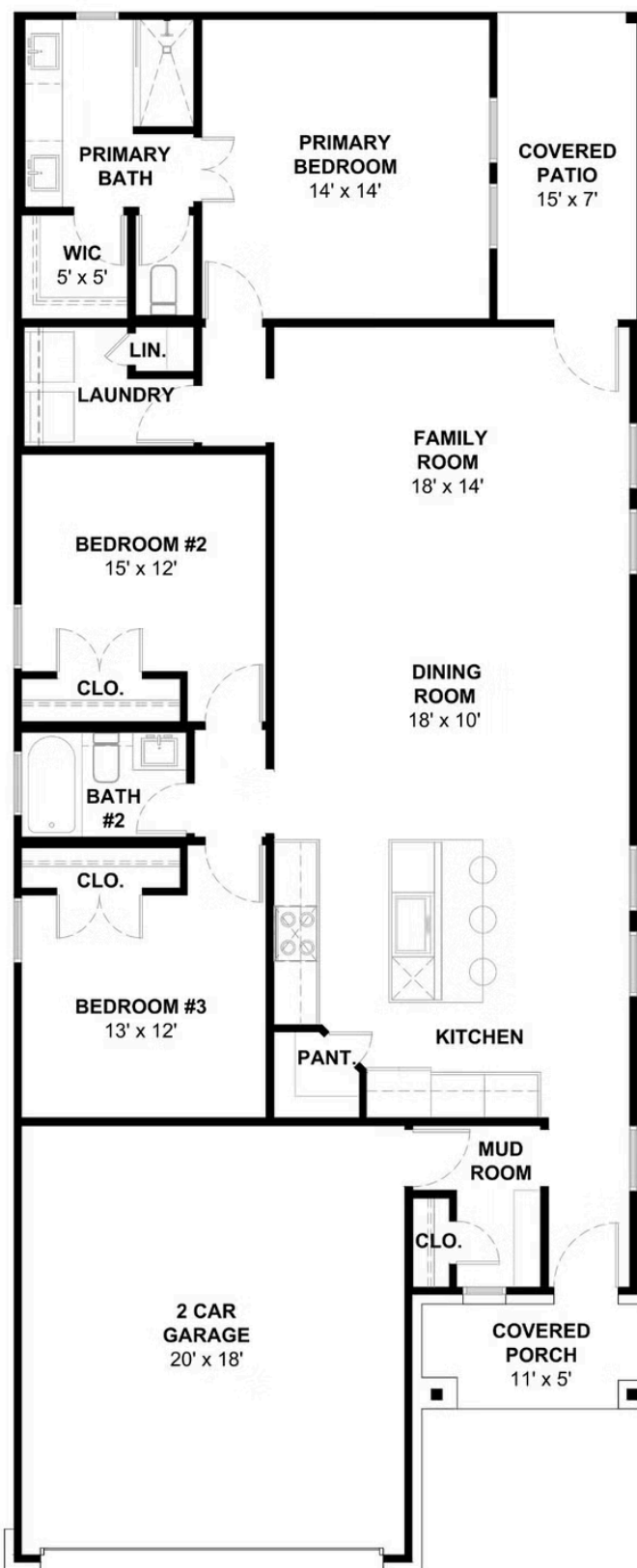

All square footage is approximate. Renderings are artist's conceptions and may vary slightly from the actual home. Homes may be built in reverse of plans shown, depending on site conditions. Minor architectural changes may be made occasionally at the option of the builder. Please contact your Sales Consultant for details.