



Single Family

Plan 3864
Junction

This beautifully designed modern farmhouse sits on a quiet 1+ acre parcel of land with peaceful views and open surroundings. The home's many features include 3 bedrooms downstairs in a split floor plan, each with its own en-suite bathroom. The primary suite offers a fabulous walk-in closet with custom built-ins. The main living space boasts vaulted ceilings with custom wood beams, an open-concept kitchen, dining, and family room anchored by a wood-burning fireplace. A chef's dream kitchen features a 48" Thermador gas range with convection double oven and an adjoining butler's pantry, making entertaining effortless. Upstairs, you'll find a 30'x12' game or bunk room with a beverage center complete with sink, wine/drink cooler, and whole-house prewired surround sound. Step outside to enjoy the custom covered patio with full outdoor kitchen and zoned irrigation. With underground utilities, thoughtful restrictions to protect your investment, and access to community water, this property offers both comfort and

Priced From
\$859,900

2 Elevations Available

-  **4** Bedrooms
-  **4.5** Bathrooms
-  **3,863+** Sq. Ft.
-  **3** Car Garage

All square footage is approximate. Renderings are artist's conceptions and may vary slightly from the actual home. Homes may be built in reverse of plans shown, depending on site conditions. Minor architectural changes may be made occasionally at the option of the builder. Please contact your Sales Consultant for details.

3864 Elevation A

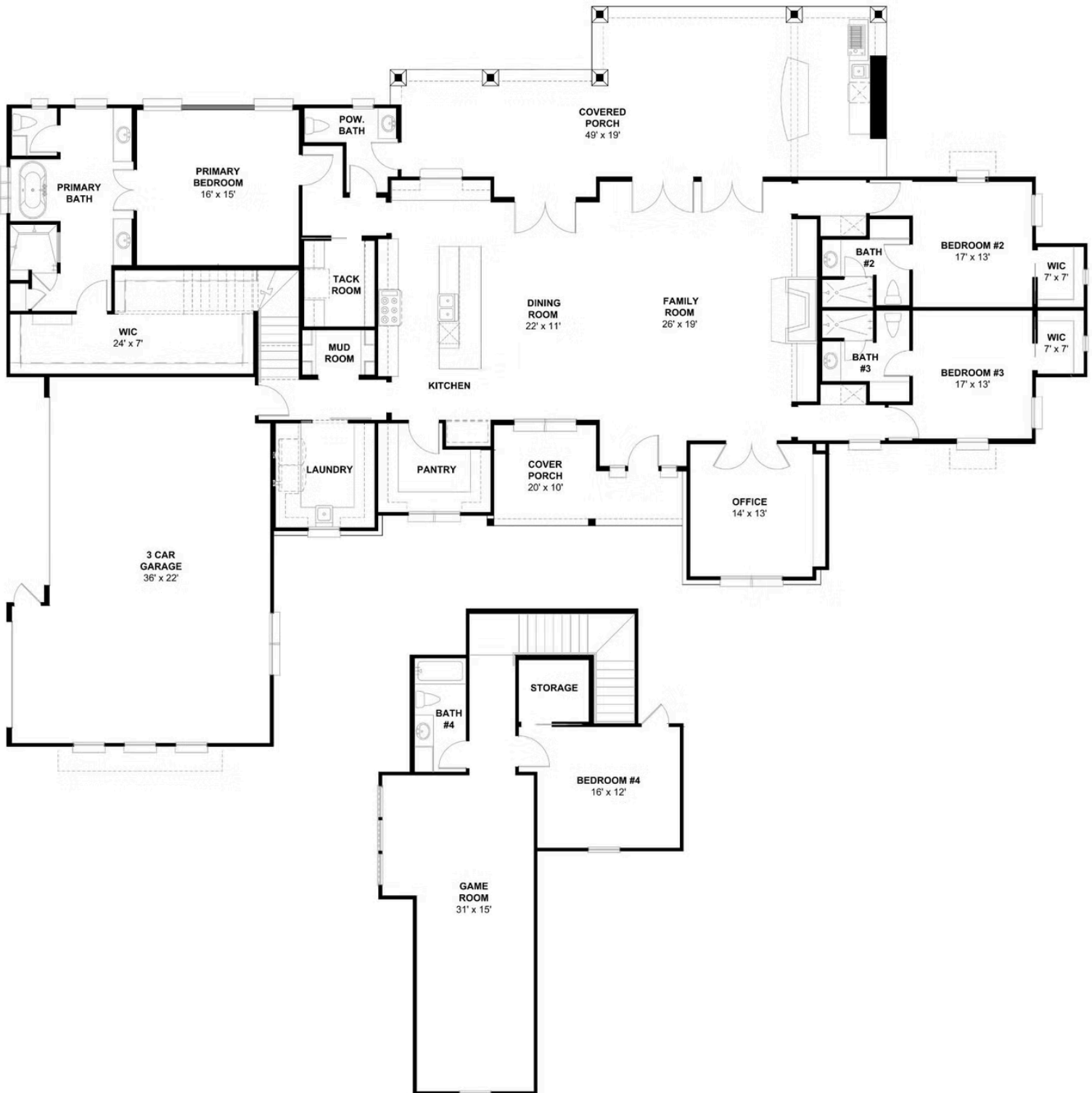

All square footage is approximate. Renderings are artist's conceptions and may vary slightly from the actual home. Homes may be built in reverse of plans shown, depending on site conditions. Minor architectural changes may be made occasionally at the option of the builder. Please contact your Sales Consultant for details.