



Single Family

Plan 3519

Junction

This 4-bedroom home at Junction features a study, game room, and private primary suite, along with split secondary bedrooms for privacy and flexibility. The open kitchen and family room flow seamlessly to an expansive covered patio, perfect for entertaining or relaxing outdoors. Living in Junction gives you the charm of a close-knit community with convenient access to shopping, dining, and everyday amenities.

For more details or to express interest, contact us today!

Priced From
\$799,900

1 Elevation Available

 **4** Bedrooms

 **3.5** Bathrooms

 **3,519+** Sq. Ft.

 **2** Car Garage



All square footage is approximate. Renderings are artist's conceptions and may vary slightly from the actual home. Homes may be built in reverse of plans shown, depending on site conditions. Minor architectural changes may be made occasionally at the option of the builder. Please contact your Sales Consultant for details.

Elevation A



All square footage is approximate. Renderings are artist's conceptions and may vary slightly from the actual home. Homes may be built in reverse of plans shown, depending on site conditions. Minor architectural changes may be made occasionally at the option of the builder. Please contact your Sales Consultant for details.

Elevation A Options

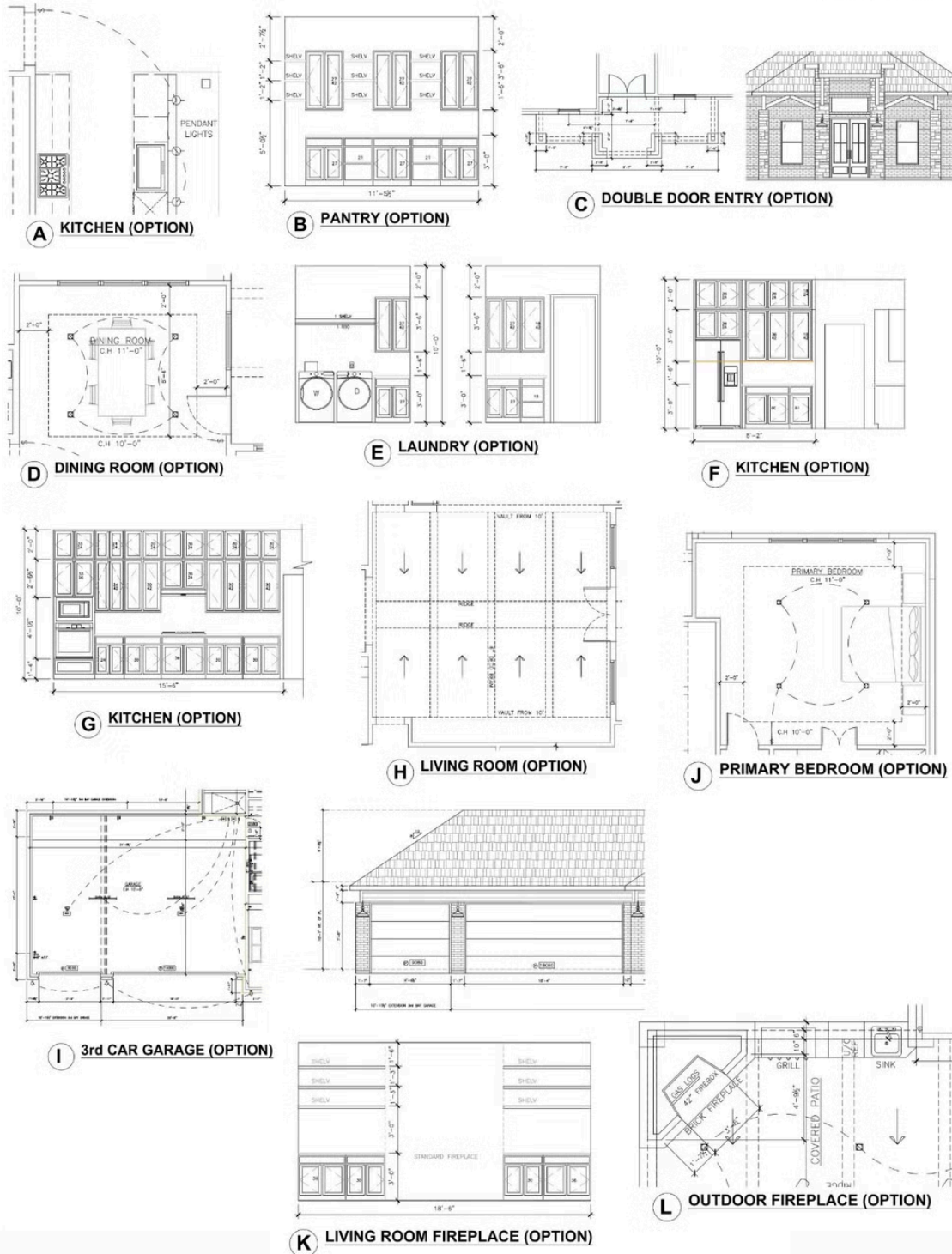

All square footage is approximate. Renderings are artist's conceptions and may vary slightly from the actual home. Homes may be built in reverse of plans shown, depending on site conditions. Minor architectural changes may be made occasionally at the option of the builder. Please contact your Sales Consultant for details.